

Leon Environmental Services

Richard "Danny" Leon CAC # 04-3708

Tommy Leon CAC # 05-3882

September 10, 2024

Manuel Villar
Golden Plains Unified School District
22000 Nevada St.
San Joaquin, CA 93660

**Re: Asbestos and Lead Limited Survey
Tranquility High School
Aquatic Center
6052 Juanche Ave.
Tranquility, CA
Job No. C121-24**

Dear Manuel:

Attached is the asbestos and lead limited survey report for the above referenced site. The report includes inspection observations; a list of all samples taken, bulk sample analysis results, a sample location drawing, and recommendations concerning asbestos and lead identified at this site.

If you have any questions or need additional information, please do not hesitate to call. Thank you for using Leon Environmental Services. We look forward to working with you in the future.

Respectfully yours,

Christopher Cabral
State of California
Division of Occupational Safety and Health
Certified Asbestos Consultant
Certification No. 22-7151
California Dept. of Public Health
Lead-Related Construction
Inspector/Assessor ID No. LRC-00009280

4545 N. Brawley Ave., Suite 104, Fresno, CA 93722
Phone: 559.274.9200 Fax: 559.274.9240 Email: LeonEnviro@leonenviro.com

Asbestos and Lead Limited Survey: Tranquility High School
6052 Juanche St, Tranquility, CA
C121-24

BUILDING DESCRIPTION

An asbestos survey was performed on **September 4, 2024** on the pool house and three pools that make up the aquatic center of **Tranquility High School** at **6052 Juanche Ave, Tranquility, CA**.

Pool House - The building is approximately 40-50 years old and approximately 650 sq. ft. It has a CMU and wood frame, CMU exterior walls, and a wood shake roof. The interior walls and ceilings are CMU and wood. The floor is bare concrete. At the time of the survey the building was vacant.

Small Pool - The pool is approximately 40-50 years old and approximately 200 sq. ft. It is an in-ground plaster pool covered with fiberglass and surrounded by a concrete deck. At the time of the survey the pool was empty.

Long Pool - The pool is approximately 40-50 years old and approximately 3,000 sq. ft. It is an in-ground plaster pool covered with fiberglass and surrounded by a concrete deck. At the time of the survey the pool was empty.

Square Pool - The pool is approximately 40-50 years old and approximately 1,000 sq. ft. It is an in-ground plaster pool surrounded by a concrete deck. At the time of the survey the pool was empty.

ASBESTOS ANALYSIS RESULTS

All bulk samples of suspect asbestos containing materials were taken in accordance with US EPA Guidelines and accepted industry standards by a state certified asbestos consultant. McCall and Spero Environmental, Inc., a NVLAP accredited laboratory performed a total of **28** analyses from **21** samples collected from this structure at this site. The full list of all samples taken is on the following pages. Sample locations are indicated on the drawings included with this report. ***Quantities listed below are estimates, for sampling purposes only, and should be verified prior to asbestos abatement.***

Sample	Location	Material	% Of ACM	Friable
Pool House				
01	Storage Room Wall	Base Cove Mastic	ND	
02	Mechanical Room Pipe Joint	Gasket Material	ND	
03	Roof	Underlayment	ND	
04	Foundation	Concrete	ND	

Asbestos and Lead Limited Survey: Tranquility High School
6052 Juanche St, Tranquility, CA
C121-24

Small Pool				
05	Pool Floor	Adhesive	ND	
06, 07	Pool Floor	White Plaster	ND	
		Grey Plaster	ND	
08, 09	Pool Coping, Pool Deck	Concrete	ND	
Long Pool				
10, 11	Pool Wall	Adhesive	ND	
12, 13, 14	Pool Wall, Pool Floor	White Plaster	ND	
		Grey Plaster	ND	
15, 16	Pool Coping, Pool Deck	Concrete	ND	
Square Pool				
17, 18, 19	Pool Wall	White Plaster	ND	
		Grey Plaster	ND	
20, 21	Pool Coping, Pool Deck	Concrete	ND	

ASBESTOS COMMENTS AND RECOMMENDATIONS

All samples of suspect materials from the selected areas were negative for asbestos.

ASBESTOS CONCLUSIONS AND REGULATIONS

US EPA NESHAP (40 CFR Part 61)

Based on our survey, sampling and subsequent laboratory analysis and regulatory guidelines affecting this site, the types of ACM identified on the previous page require removal (in most cases) prior to demolition and/or renovation procedures to comply with local, state and federal agencies. The US EPA NESHAP (40 CFR Part 61 – November 20, 1990) requires materials containing greater than one percent asbestos be removed prior to renovation or demolition. If those materials are friable or likely to become friable

Asbestos and Lead Limited Survey: Tranquility High School
6052 Juanche St, Tranquility, CA
C121-24

due to the forces expected to act upon them during renovation or demolition, they become a regulated asbestos containing material (RACM) and require a 10-day notification to the local Air Pollution Control District prior to abatement.

Non-friable and non-regulated ACM, in most cases, may be disposed of as a Non-Hazardous waste in a landfill that accepts Asbestos Containing Materials. All friable waste containing more than 1% asbestos (RACM) should be manifested as hazardous waste for disposal purposes.

CAL OSHA-----Construction Industry-----8CCR, 1529

Cal/OSHA worker health and safety regulations apply during any disturbance of ACM by a person while in the employ of another. This is true regardless of friability or quantity disturbed. If there is greater than 100 square feet of ACM which will be affected by the demolition, a California Licensed Contractor who is registered with Cal/OSHA for asbestos is required. The regulations regarding asbestos are found in Title 8 CCR Section 1529, and also include formal notification requirements to Cal/OSHA at least 24 hours prior to removal. It is required that removal be conducted with the material kept in a wetted state to contain dust and hazardous emissions.

The construction industry standard covers employees engaged in demolition and construction, and the following related activities likely to involve asbestos exposure: removal, encapsulation, alteration, repair, maintenance, insulation, spill emergency cleanup, transportation, disposal and storage of ACM.

Demolition contractors typically require that a building owner/operator accept responsibility for removal of all ACM found during the building inspection prior to start of demolition activities.

LEAD BASED PAINT ANALYSIS RESULTS
--

The sample collection areas were determined by the information given to the inspector by **Blanca Mercedes of Maas Companies** about the impending remodel/renovation that is planned for this building. All paint samples were analyzed according to HUD Guidelines by XRF.

**All samples of suspect paint from the selected areas
were below the 1.0 mg/cm² level.
Please See Table 1.**

LBP COMMENTS AND RECOMMENDATIONS

All paint samples tested for this survey were below the 1.0 mg/cm² level by XRF established by HUD to be considered a Lead Based Paint (LBP). All homes built prior to

Asbestos and Lead Limited Survey: Tranquility High School
6052 Juanche St, Tranquility, CA
C121-24

1978 are assumed to contain Lead Based Paint. Although limited paint chip samples came back negative for Lead, Lead safe work practices should be in place during any construction or demolition that would affect these areas.

The federal and CALOSHA regulations for lead in construction do not specify a level of a lead in paint that classifies it as LBP. However, federal and state OSHA regulations specify **airborne lead levels** that should not be exceeded during construction without appropriate protection and training.

The action level for lead is 30 micrograms per cubic meter of air ($\mu\text{g}/\text{m}^3$) and the permissible exposure limit (PEL) is $50\mu\text{g}/\text{m}^3$. These airborne lead levels can be exceeded during construction or demolition activities such as scraping, sanding, grinding, blasting, and torching LBP surfaces, even when levels of lead in paint are far below the HUD definition of LBP of $1.0 \text{ mg}/\text{cm}^2$ or 0.5 percent lead by weight.

OSHA Lead in Construction Standard Cal/OSHA 8 CCR 1532.1 shall apply whenever construction work is conducted where employees may be exposed to lead.

Beginning April 2010, new federal law (**EPA RRP rule**) will require that contractors performing renovation, repair and painting projects that disturb lead-based paint in homes, child care facilities and schools built before 1978 that a child under age six visits regularly to be certified and follow specific work practices to prevent lead contamination. Also, beginning April 2010, federal law will require contractors that disturb lead-based paint in homes, child care facilities and schools, built before 1978 to be certified and follow specific work practices to prevent lead contamination.

LBP CONCLUSIONS AND REGULATIONS

The Department of Housing and Urban Development (HUD) considers a paint to be a lead-based paint hazard when the content of the paint exceeds 0.5% or 5000ppm. California Occupational Safety and Health (OSHA) regulations require employee personnel monitoring at any detectable levels until statistically reliable results indicate that exposure will remain consistently below the OSHA Action Level of 30 micrograms/ m^3 and the Permissible Exposure Level of 50 micrograms/ m^3 for an 8 hour day. The employer must then produce a "Negative Exposure Assessment" to indicate that it is not possible with the specific lead-based paint product to create excessive lead exposure levels.

LIMITATIONS OF LIABILITY

Conclusions and recommendations presented in this report are qualitative judgments based on the prevailing regulations and accepted industry standards at the time of the report issuance. Leon Environmental Services provides no other guarantees, either expressed or implied. All quantities of materials listed herein are estimates for sampling purposes only, and should be verified by Owner representative or an abatement / demolition contractor prior to asbestos abatement or demolition.

Asbestos and Lead Limited Survey: Tranquility High School
6052 Juanche St, Tranquility, CA
C121-24

The nature of demolition is such that materials can be uncovered which previously were unknown to exist. Therefore, Leon Environmental Services cannot be responsible for materials not previously detected due to lack of accessibility or concealment, although every effort was made during the inspection to detect all suspect materials. If any suspect materials other than those included herein are discovered during renovation or demolition, it must be assumed that the materials are asbestos containing, and should be treated accordingly until further testing and analysis is performed.

The data interpretations and recommendations are based solely on information available to Leon Environmental Services at the time of our inspection. The customer recognizes that site conditions or accessibility may vary, from those encountered at the time of our inspection and sample collection. Varying conditions or access could result in additional information that would lead us to revise conclusions and recommendations. Leon Environmental Services will not be responsible for the interpretation or use by others of information contained within this report.

Christopher Cabral
Certified Asbestos Consultant
Certification No. 22-7151
State of California Department of Public Health
Lead Inspector Assessor No. LRC-00009280

Date

*Abbreviation Key:

Asbestos Containing Material — ACM (equal to or greater than 0.1% by weight)

Vinyl Asbestos Tile — VAT

No Asbestos Detected--N.A.D or N.D.

Homogeneous—H

Not Sampled—NS

Leon Environmental Services

Richard "Danny" Leon CAC Certification No. 04-3708

Tommy Leon CAC Certification No. 05-3882

Job C121-24 / Sample Location Diagram

Tranquility High School, Aquatic Center / 6052 Juanche Ave, Tranquility, CA

Manuel Villar / Golden Plains Unified School District

Drawing not to Scale

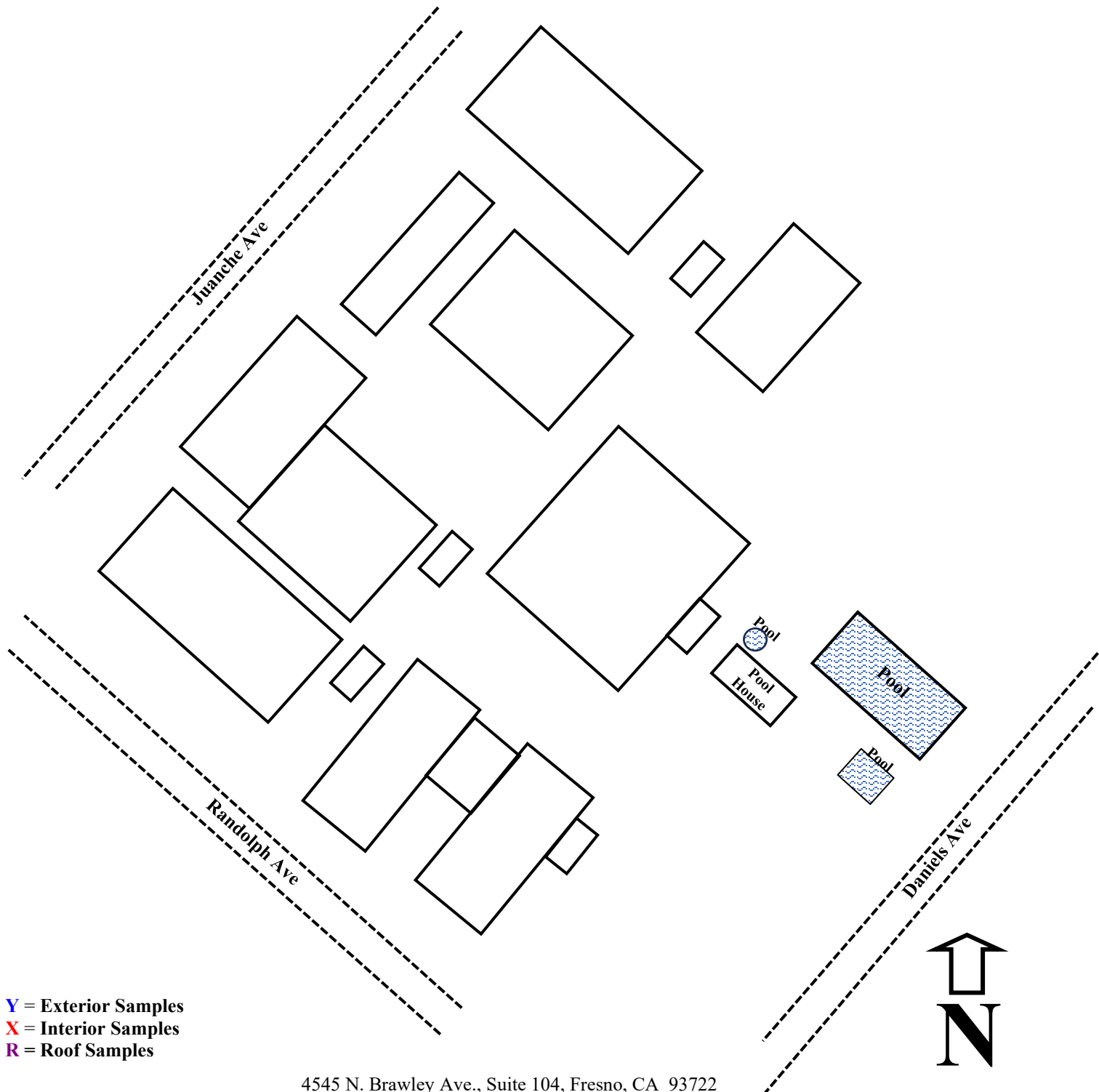

4545 N. Brawley Ave., Suite 104, Fresno, CA 93722

Phone: 559.274.9200 Fax: 559.274.9240 Email: LeonEnviro@leonenviro.com

Leon Environmental Services

Richard "Danny" Leon CAC Certification No. 04-3708

Tommy Leon CAC Certification No. 05-3882

Job C121-24 / Sample Location Diagram

Tranquility High School, Aquatic Center / 6052 Juanche Ave, Tranquility, CA

Manuel Villar / Golden Plains Unified School District

Drawing Not to Scale

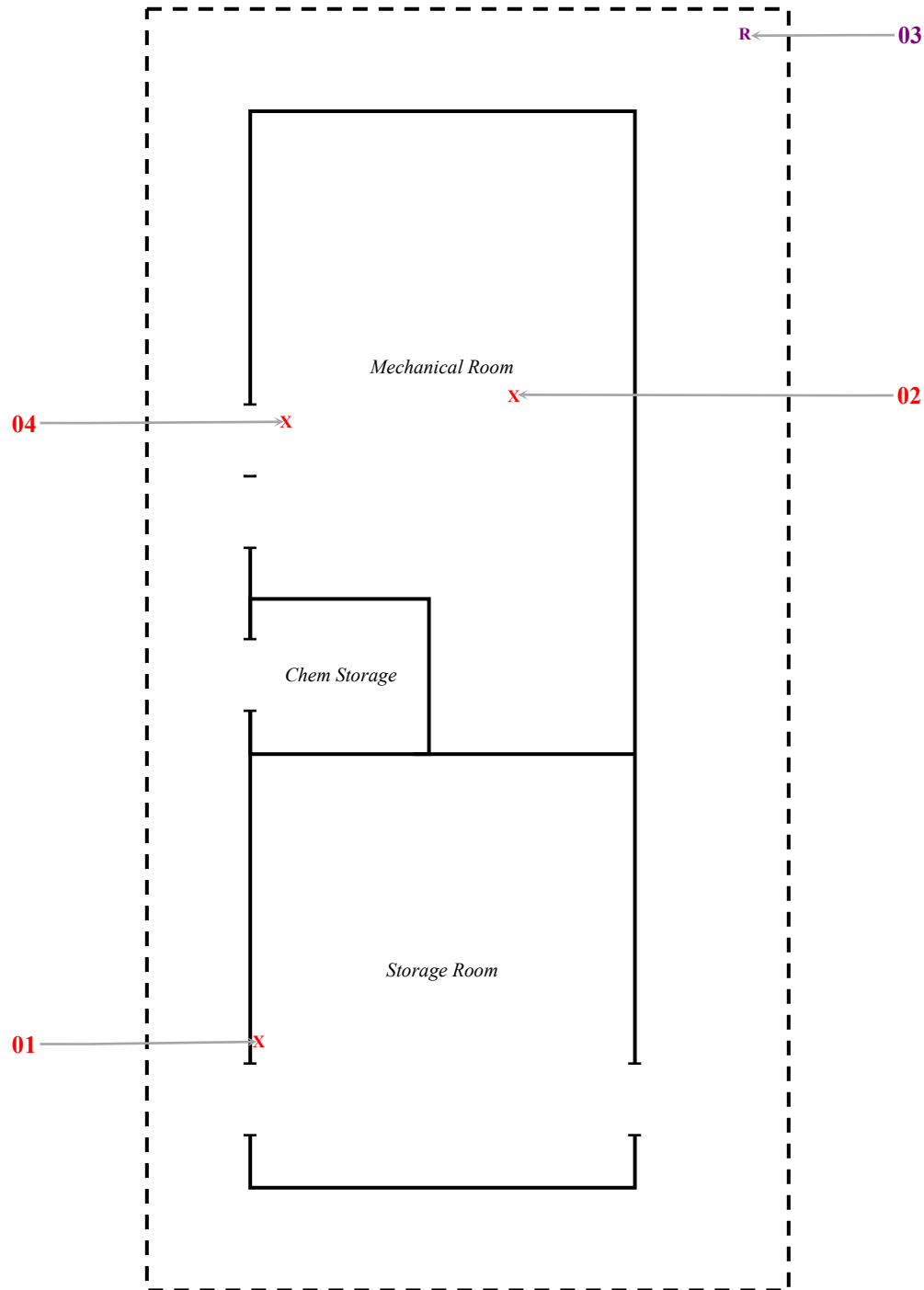

X = Interior Samples
Y = Exterior Samples
R = Roof Samples

4545 N. Brawley Ave., Suite 104, Fresno, CA 93722
Phone: 559.274.9200 Fax: 559.274.9240 Email: LeonEnviro@comcast.net



Leon Environmental Services

Richard "Danny" Leon CAC Certification No. 04-3708

Tommy Leon CAC Certification No. 05-3882

Job C121-24 / Sample Location Diagram

Tranquility High School, Aquatic Center / 6052 Juanche Ave, Tranquility, CA

Manuel Villar / Golden Plains Unified School District

Drawing not to Scale

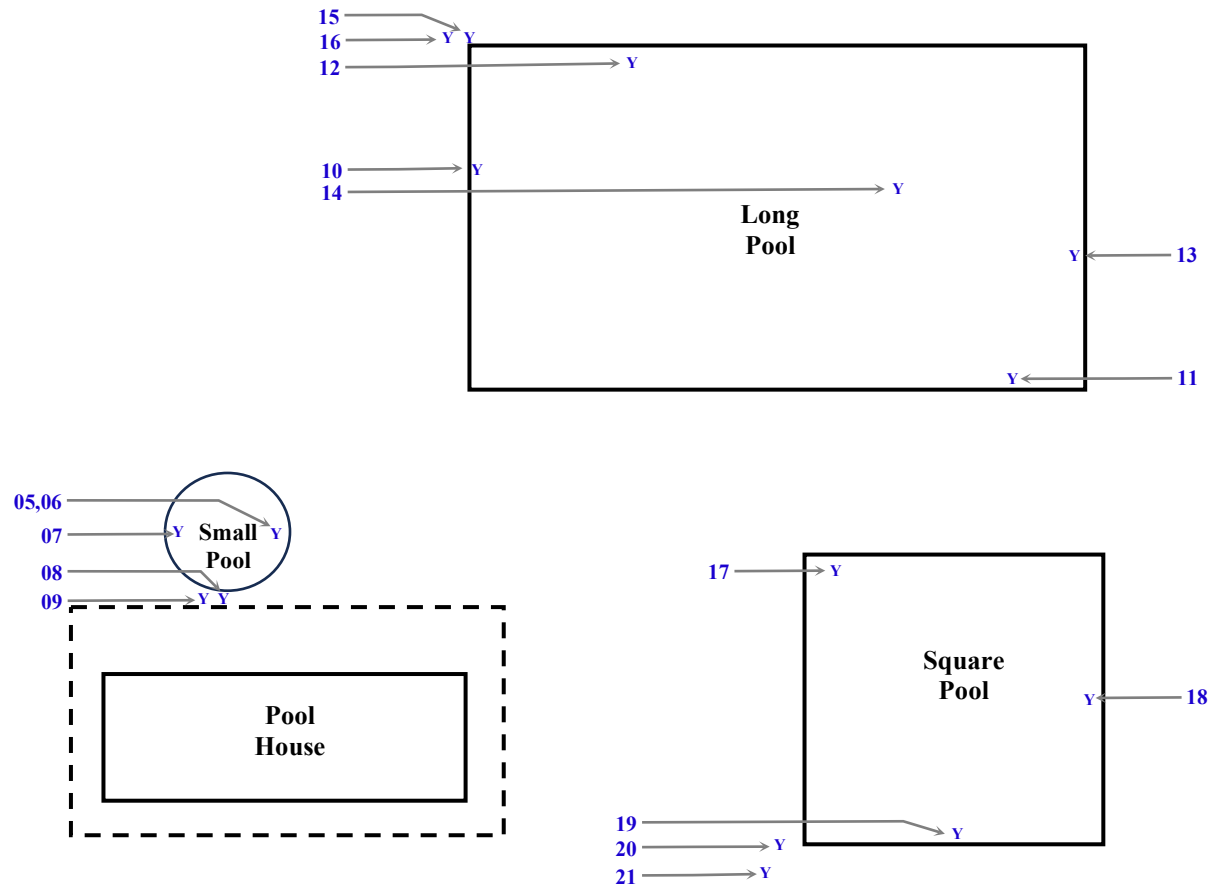

Y = Exterior Samples
X = Interior Samples
R = Roof Samples





McCall and Spero
Environmental, Inc.

Specialists in Microanalysis

1831 Williamson Court • Suite 100 • Louisville, KY 40223
Phone (502) 244-7135 • FAX (502) 244-7136

E-mail: customerservice@mselabs.com • Website: www.mselabs.com

Date: September 9, 2024

Attention: Tommy Leon
Leon Environmental Services

Subject: Analysis of bulk samples for asbestos mineral fibers by Polarized Light
Microscopy (PLM) with Dispersion Staining (EPA/600/R-93/116)

RE: MSE-P954LEO
Manuel Villa, Golden Plains Unified School District - Tranquility High
School: 6052 Juanche St; Tranquility, CA Project
LEO# C121-24

Dear Mr. Leon:

McCall & Spero Environmental, Inc. has completed the analysis of the bulk samples we received from your offices on September 5, 2024. These samples represent the bulk samples from the Manuel Villa, Golden Plains Unified School District - Tranquility High School: 6052 Juanche St; Tranquility, CA Project.

The PLM bulk analysis was performed according to the "Method of the Determination of Asbestos in Bulk Building Materials", R. L. Perkins and B. W. Harvey (EPA/600/R-93/116).

The results for the twenty-eight (28) samples are summarized in the following report. Please note that for samples consisting of two or more distinct components, each component is analyzed and reported individually (EPA 40 CFR Part 61 [FRL-4821-71]).

Thank you for consulting McCall & Spero Environmental, Inc. Should you have any questions concerning these results, please contact our office.

Sincerely,

Taylor B. Stone
Senior Analyst

SUMMARY OF PLM BULK ANALYSIS RESULTS

Page 1

Project Name: Manuel Villa, Golden Plains Unified School District - Tranquility High School: 6052 Juanche St;
Tranquility, CA Project

McCall & Spero Environmental Project No. MSE-P954LEO

MSE # P954LEO	SAMPLE # DESCRIPTION	ASBESTOS TYPE & %	OTHER FIBROUS MATERIAL & %	% NON-FIBROUS MATERIAL	COLOR
001	01 Base Cove Mastic	ND	Cellulose / 5%	95%	Gray
002	02 Gasket Material	ND	Cellulose / 15%	85%	White
003	03 Underlayment	ND	Cellulose / 10% Glass / 30%	60%	Black
004	04 Concrete	ND	Cellulose / 3%	97%	Gray
005	05 Adhesive	ND	Cellulose / 10% Glass / 10%	80%	Blue/White
006 (A)	06 (A) Plaster	ND	Cellulose / 3%	97%	White
006 (B)	06 (B) Plaster	ND	Cellulose / 3%	97%	White
007 (A)	07 (A) Plaster	ND	Cellulose / 3%	97%	Gray
007 (B)	07 (B) Plaster	ND	Cellulose / 3%	97%	Gray
008	08 Concrete	ND	Cellulose / 2%	98%	Gray
009	09 Concrete	ND	Cellulose / 2%	98%	Gray
010	10 Adhesive	ND	Cellulose / 10%	90%	White
011	11 Adhesive	ND	Cellulose / 7%	93%	Clear
012 (A)	12 (A) Plaster	ND	Cellulose / 3%	97%	White

McCall & Spero Environmental, Inc.

SUMMARY OF PLM BULK ANALYSIS RESULTS

Page 2

MSE # P954LEO	SAMPLE # DESCRIPTION	ASBESTOS TYPE & %	OTHER FIBROUS MATERIAL & %	% NON-FIBROUS MATERIAL	COLOR
012 (B)	12 (B) Plaster	ND	Cellulose / 3%	97%	Gray
013 (A)	13 (A) Plaster	ND	Cellulose / 3%	97%	White
013 (B)	13 (B) Plaster	ND	Cellulose / 3%	97%	Gray
014 (A)	14 (A) Plaster	ND	Cellulose / 3%	97%	White
014 (B)	14 (B) Plaster	ND	Cellulose / 3%	97%	Gray
015	15 Concrete	ND	Cellulose / 2%	98%	Gray
016	16 Concrete	ND	Cellulose / 2%	98%	Gray
017 (A)	17 (A) Plaster	ND	Cellulose / 3%	97%	White
017 (B)	17 (B) Plaster	ND	Cellulose / 3%	97%	Gray
018 (A)	18 (A) Plaster	ND	Cellulose / 3%	97%	White
018 (B)	18 (B) Plaster	ND	Cellulose / 3%	97%	Gray
019 (A)	19 (A) Plaster	ND	Cellulose / 3%	97%	White
019 (B)	19 (B) Plaster	ND	Cellulose / 3%	97%	Gray
020	20 Concrete	ND	Cellulose / 2%	98%	Gray
021	21 Concrete	ND	Cellulose / 2%	98%	Gray

McCall & Spero Environmental, Inc.

SUMMARY OF PLM BULK ANALYSIS RESULTS

Page 3

NOTES:

ND = None Detected
CR = Crocidolite

CH = Chrysotile
AN = Anthophyllite

A = Amosite
TR = Tremolite

AC = Actinolite

For samples consisting of separate components, each component is analyzed and reported separately.

Results apply only to items tested. Quantification is accurate to within $\pm 10\%$. Results from this report must not be reproduced, except in full, with the approval of McCall & Spero Environmental, Inc. This report must not be used to claim product endorsement by NVLAP or any agency of the U.S. Government.

** EPA recommends that bulk materials found negative for asbestos or less than one percent asbestos by polarized light microscopy that fall into one of five dominantly nonfriable categories be reanalyzed by an additional method, such as transmission electron microscopy. (EPA Notice of Advisory, FR Vol. 59, No. 146 & Test Method EPA 600/ R-93/ 116).

Analyst: Taylor B. Stone

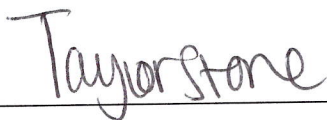

McCall & Spero Environmental, Inc.

Leon Environmental Services

4545 N. Brawley Ave., Suite 104, Fresno, CA 93722 Phone: (559) 274-9200 Fax: (559) 274-9240 Email: Leonenviro@comcast.net

Customer: Manuel Villar

Company: Golden Plains Unified School District

Date: September 4, 2024

Job No: C121-24

Analysis: PLM

Turn Around:

RUSH

Same Day

Next Day

2-3 Days

4-5 Days

Inspection Site: Tranquility High School, 6052 Juanche St, Tranquility, CA

Sample No.	Location	Material		Quantity
		Color	Type	
	Pool House			
01	Storage Room Wall		Base Cove Mastic	
02	Mechanical Room Pipe Joint		Gasket Material	
03	Roof		Underlayment	
04	Foundation		Concrete	
	Small Pool			
05	Pool Floor		Adhesive	
06	Pool Floor	White	Plaster	
	Pool Floor	Grey	Plaster	
07	Pool Floor	White	Plaster	
	Pool Floor	Grey	Plaster	
08	Pool Coping		Concrete	
09	Pool Deck		Concrete	
	Long Pool			
10	Pool Wall		Adhesive	
11	Pool Wall		Adhesive	
12	Pool Wall	White	Plaster	
	Pool Wall	Grey	Plaster	
13	Pool Wall	White	Plaster	

Relinquished

By:

Chet Chl

Date:

9-4-24

Received

By:

Taylor Stone

Date:

9/5/24

Leon Environmental Services

4545 N. Brawley Ave., Suite 104, Fresno, CA 93722 Phone: (559) 274-9200 Fax: (559) 274-9240 Email: Leonenviro@comcast.net

Customer: Manuel Villar

Company: Golden Plains Unified School District

Date: September 4, 2024

Job No: C121-24

Analysis: PLM

Turn Around:

RUSH

Same Day

Next Day

2-3 Days

4-5 Days

Inspection Site: Tranquility High School, 6052 Juanche St, Tranquility, CA

Sample No.	Location	Material		Quantity
		Color	Type	
13	Pool Wall	Grey	Plaster	
14	Pool Floor	White	Plaster	
	Pool Floor	Grey	Plaster	
15	Pool Coping		Concrete	
16	Pool Deck		Concrete	
	Square Pool			
17	Pool Wall	White	Plaster	
	Pool Wall	Grey	Plaster	
18	Pool Wall	White	Plaster	
	Pool Wall	Grey	Plaster	
19	Pool Wall	White	Plaster	
	Pool Wall	Grey	Plaster	
20	Pool Coping		Concrete	
21	Pool Deck		Concrete	

Relinquished

By:

Chet Ch

Date:

9-4-24

Received

By:

Taylor Stone

Date:

9/5/24

Reading No	Type	Units	Building	Room	Side	Component	Substrate	Color	Results	PbC
7	PAINT	mg / cm ²	POOL HOUSE	MECHANICAL	A	WALL	CMU	GREY	Negative	0.10
8	PAINT	mg / cm ²	POOL HOUSE	MECHANICAL	A	WALL	CMU	GREY	Negative	0.00
9	PAINT	mg / cm ²	POOL HOUSE	MECHANICAL	B	WALL	CMU	GREY	Negative	0.20
10	PAINT	mg / cm ²	POOL HOUSE	MECHANICAL	B	WALL	CMU	GREY	Negative	0.10
11	PAINT	mg / cm ²	POOL HOUSE	MECHANICAL	C	WALL	CMU	GREY	Negative	0.10
12	PAINT	mg / cm ²	POOL HOUSE	MECHANICAL	C	WALL	CMU	GREY	Negative	0.10
13	PAINT	mg / cm ²	POOL HOUSE	MECHANICAL	C	DOOR FRAME	METAL	BLUE	Negative	0.00
14	PAINT	mg / cm ²	POOL HOUSE	MECHANICAL	C	DOOR FRAME	METAL	BLUE	Negative	0.70
15	PAINT	mg / cm ²	POOL HOUSE	MECHANICAL	C	DOOR FRAME	METAL	BLUE	Negative	0.70
16	PAINT	mg / cm ²	POOL HOUSE	MECHANICAL	C	DOOR	METAL	BLUE	Negative	0.50
17	PAINT	mg / cm ²	POOL HOUSE	MECHANICAL	C	DOOR	METAL	BLUE	Negative	0.80
18	PAINT	mg / cm ²	POOL HOUSE	MECHANICAL	D	WALL	CMU	GREY	Negative	0.10
19	PAINT	mg / cm ²	POOL HOUSE	MECHANICAL	D	WALL	CMU	GREY	Negative	0.20
20	PAINT	mg / cm ²	POOL HOUSE	MECHANICAL	D	PANEL	WOOD	GREY	Negative	0.00
21	PAINT	mg / cm ²	POOL HOUSE	MECHANICAL	D	PANEL	WOOD	GREY	Negative	0.20
22	PAINT	mg / cm ²	POOL HOUSE	MECHANICAL		TANK 1	METAL	BLUE	Negative	0.20
23	PAINT	mg / cm ²	POOL HOUSE	MECHANICAL		TANK 1	METAL	BLUE	Negative	0.50
24	PAINT	mg / cm ²	POOL HOUSE	MECHANICAL		TANK 2	METAL	BLUE	Negative	0.00
25	PAINT	mg / cm ²	POOL HOUSE	MECHANICAL		TANK 2	METAL	BLUE	Negative	0.00
26	PAINT	mg / cm ²	POOL HOUSE	CHEM STORAGE	A	WALL	CMU	GREY	Negative	0.20
27	PAINT	mg / cm ²	POOL HOUSE	CHEM STORAGE	A	WALL	CMU	GREY	Negative	0.10
28	PAINT	mg / cm ²	POOL HOUSE	CHEM STORAGE	B	WALL	CMU	GREY	Negative	0.10
29	PAINT	mg / cm ²	POOL HOUSE	CHEM STORAGE	C	WALL	CMU	GREY	Negative	0.10
30	PAINT	mg / cm ²	POOL HOUSE	CHEM STORAGE	C	WALL	CMU	GREY	Negative	0.10
31	PAINT	mg / cm ²	POOL HOUSE	CHEM STORAGE	C	DOOR FRAME	METAL	GREY	Negative	0.10
32	PAINT	mg / cm ²	POOL HOUSE	CHEM STORAGE	C	DOOR FRAME	METAL	GREY	Negative	0.10
33	PAINT	mg / cm ²	POOL HOUSE	CHEM STORAGE	C	DOOR	METAL	BLUE	Negative	0.00
34	PAINT	mg / cm ²	POOL HOUSE	CHEM STORAGE	C	DOOR	METAL	BLUE	Negative	0.00

35	PAINT	mg / cm ²	POOL HOUSE	CHEM STORAGE	D	WALL	CMU	GREY	Negative	0.10
36	PAINT	mg / cm ²	POOL HOUSE	CHEM STORAGE	D	WALL	CMU	GREY	Negative	0.10
37	PAINT	mg / cm ²	POOL HOUSE	STORAGE	A	WINDOW FRAME	METAL	BLUE	Negative	0.30
38	PAINT	mg / cm ²	POOL HOUSE	STORAGE	A	WINDOW FRAME	METAL	BLUE	Negative	0.20
39	PAINT	mg / cm ²	POOL HOUSE	STORAGE	A	SHUTTER	METAL	BLUE	Negative	0.10
40	PAINT	mg / cm ²	POOL HOUSE	STORAGE	A	SHUTTER	METAL	BLUE	Negative	0.20
41	PAINT	mg / cm ²	POOL HOUSE	STORAGE	A	COUNTER TOP	WOOD	VARNISH	Negative	0.10
42	PAINT	mg / cm ²	POOL HOUSE	STORAGE	A	COUNTER TOP	WOOD	VARNISH	Negative	0.20
43	PAINT	mg / cm ²	POOL HOUSE	STORAGE	A	CABINET	WOOD	BLUE	Negative	0.00
44	PAINT	mg / cm ²	POOL HOUSE	STORAGE	B	CABINET	WOOD	BLUE	Negative	0.10
45	PAINT	mg / cm ²	POOL HOUSE	STORAGE	B	CABINET	WOOD	BLUE	Negative	0.00
46	PAINT	mg / cm ²	POOL HOUSE	STORAGE	B	WINDOW FRAME	METAL	BLUE	Negative	0.20
47	PAINT	mg / cm ²	POOL HOUSE	STORAGE	B	WINDOW FRAME	METAL	BLUE	Negative	0.20
48	PAINT	mg / cm ²	POOL HOUSE	STORAGE	B	SHUTTER	METAL	BLUE	Negative	0.10
49	PAINT	mg / cm ²	POOL HOUSE	STORAGE	B	SHUTTER	METAL	BLUE	Negative	0.20
50	PAINT	mg / cm ²	POOL HOUSE	STORAGE	B	WALL	CMU	GREY	Negative	0.00
51	PAINT	mg / cm ²	POOL HOUSE	STORAGE	B	WALL	CMU	GREY	Negative	0.10
52	PAINT	mg / cm ²	POOL HOUSE	STORAGE	A	DOOR	METAL	GREY	Negative	0.10
53	PAINT	mg / cm ²	POOL HOUSE	STORAGE	A	DOOR	METAL	GREY	Negative	0.10
54	PAINT	mg / cm ²	POOL HOUSE	STORAGE	A	DOOR FRAME	METAL	BLUE	Negative	0.10
55	PAINT	mg / cm ²	POOL HOUSE	STORAGE	A	DOOR FRAME	METAL	BLUE	Negative	0.40
56	PAINT	mg / cm ²	POOL HOUSE	STORAGE	C	DOOR FRAME	METAL	BLUE	Negative	0.00
57	PAINT	mg / cm ²	POOL HOUSE	STORAGE	C	DOOR FRAME	METAL	BLUE	Negative	0.50
58	PAINT	mg / cm ²	POOL HOUSE	STORAGE	C	DOOR	METAL	BLUE	Negative	0.10
59	PAINT	mg / cm ²	POOL HOUSE	STORAGE	C	DOOR	METAL	BLUE	Negative	0.10
60	PAINT	mg / cm ²	POOL HOUSE	STORAGE	C	WALL	CMU	GREY	Negative	0.10
61	PAINT	mg / cm ²	POOL HOUSE	STORAGE	C	SHUTTER	METAL	BLUE	Negative	0.10
62	PAINT	mg / cm ²	POOL HOUSE	STORAGE	C	SHUTTER	METAL	BLUE	Negative	0.20

63	PAINT	mg / cm ²	POOL HOUSE	STORAGE	D	WALL	CMU	GREY	Negative	0.20
64	PAINT	mg / cm ²	POOL HOUSE	STORAGE	D	WALL	CMU	GREY	Negative	0.10
65	PAINT	mg / cm ²	POOL HOUSE	STORAGE	D	PANEL	METAL	GREY	Negative	0.20
66	PAINT	mg / cm ²	POOL HOUSE	STORAGE	D	PANEL	METAL	GREY	Negative	0.10
67	PAINT	mg / cm ²	POOL HOUSE	STORAGE		CEILING	WOOD	WHITE	Negative	0.10
68	PAINT	mg / cm ²	POOL HOUSE	STORAGE		CEILING	WOOD	WHITE	Negative	0.10
69	PAINT	mg / cm ²	POOL HOUSE	CHEM STORAGE		CEILING	WOOD	WHITE	Negative	0.10
70	PAINT	mg / cm ²	POOL HOUSE	CHEM STORAGE		CEILING	WOOD	WHITE	Negative	0.10
71	PAINT	mg / cm ²	POOL HOUSE	MECHANICAL		CEILING	WOOD	WHITE	Negative	0.00
72	PAINT	mg / cm ²	POOL HOUSE	MECHANICAL		CEILING	WOOD	WHITE	Negative	0.10
73	PAINT	mg / cm ²	POOL HOUSE	EXTERIOR	A	WALL	CMU	GREY	Negative	0.10
74	PAINT	mg / cm ²	POOL HOUSE	EXTERIOR	A	WINDOW SILL	METAL	BEIGE	Negative	0.20
75	PAINT	mg / cm ²	POOL HOUSE	EXTERIOR	A	WINDOW SILL	METAL	BEIGE	Negative	0.10
76	PAINT	mg / cm ²	POOL HOUSE	EXTERIOR	A	SHUTTER	METAL	BEIGE	Negative	0.10
77	PAINT	mg / cm ²	POOL HOUSE	EXTERIOR	A	SHUTTER	METAL	BEIGE	Negative	0.10
78	PAINT	mg / cm ²	POOL HOUSE	EXTERIOR	A	DOOR FRAME	WOOD	BEIGE	Negative	0.00
79	PAINT	mg / cm ²	POOL HOUSE	EXTERIOR	A	DOOR FRAME	WOOD	BEIGE	Negative	0.70
80	PAINT	mg / cm ²	POOL HOUSE	EXTERIOR	B	WINDOW SILL	WOOD	BEIGE	Negative	0.40
81	PAINT	mg / cm ²	POOL HOUSE	EXTERIOR	B	WINDOW SILL	WOOD	BEIGE	Negative	0.30
82	PAINT	mg / cm ²	POOL HOUSE	EXTERIOR	B	SHUTTER	METAL	BEIGE	Negative	0.20
83	PAINT	mg / cm ²	POOL HOUSE	EXTERIOR	C	DOOR FRAME	METAL	BEIGE	Negative	0.50
84	PAINT	mg / cm ²	POOL HOUSE	EXTERIOR	C	DOOR FRAME	METAL	BEIGE	Negative	0.50
85	PAINT	mg / cm ²	POOL HOUSE	EXTERIOR	D	WINDOW SILL	METAL	BEIGE	Negative	0.30
86	PAINT	mg / cm ²	POOL HOUSE	EXTERIOR	D	SHUTTER	METAL	BEIGE	Negative	0.20
87	PAINT	mg / cm ²	POOL HOUSE	EXTERIOR	D	DOOR FRAME	METAL	BEIGE	Negative	0.10
88	PAINT	mg / cm ²	POOL HOUSE	EXTERIOR	D	DOOR FRAME	METAL	BEIGE	Negative	0.40
89	PAINT	mg / cm ²	POOL HOUSE	STORAGE		CAROUSEL	METAL	BLUE	Negative	0.10
90	PAINT	mg / cm ²	POOL HOUSE	STORAGE		CAROUSEL	METAL	BLUE	Negative	0.10

91	PAINT	mg / cm ²	POOL HOUSE	EXTERIOR	A	EAVE	WOOD	BEIGE	Negative	0.10
92	PAINT	mg / cm ²	POOL HOUSE	EXTERIOR	A	EAVE	WOOD	BEIGE	Negative	0.10
93	PAINT	mg / cm ²	POOL HOUSE	EXTERIOR	A	DOWN SPOUT	METAL	BEIGE	Negative	0.30
94	PAINT	mg / cm ²	POOL HOUSE	EXTERIOR	A	DOWN SPOUT	METAL	BEIGE	Negative	0.20
95	PAINT	mg / cm ²	POOL HOUSE	EXTERIOR	A	FASCIA	METAL	BLUE	Negative	0.20
96	PAINT	mg / cm ²	POOL HOUSE	EXTERIOR	A	FASCIA	METAL	BLUE	Negative	0.10
97	PAINT	mg / cm ²	POOL HOUSE	EXTERIOR	B	FASCIA	METAL	BLUE	Negative	0.30
98	PAINT	mg / cm ²	POOL HOUSE	EXTERIOR	C	FASCIA	WOOD	BLUE	Negative	0.10
99	PAINT	mg / cm ²	POOL HOUSE	EXTERIOR	C	EAVE	WOOD	BLUE	Negative	0.10
100	PAINT	mg / cm ²	POOL HOUSE	EXTERIOR	C	EAVE	WOOD	BLUE	Negative	0.10
101	PAINT	mg / cm ²	LONG POOL	EXTERIOR	A	WALL	PLASTER	WHITE	Negative	0.50
102	PAINT	mg / cm ²	LONG POOL	EXTERIOR	A	WALL	PLASTER	WHITE	Negative	0.30
103	PAINT	mg / cm ²	LONG POOL	EXTERIOR	C	WALL	PLASTER	WHITE	Negative	0.00
104	PAINT	mg / cm ²	LONG POOL	EXTERIOR	C	WALL	PLASTER	WHITE	Negative	0.10
105	PAINT	mg / cm ²	SQUARE POOL	EXTERIOR	B	WALL	PLASTER	WHITE	Negative	0.00
106	PAINT	mg / cm ²	SQUARE POOL	EXTERIOR	B	WALL	PLASTER	WHITE	Negative	0.00
107	PAINT	mg / cm ²	SQUARE POOL	EXTERIOR	D	WALL	PLASTER	TAN	Negative	0.30
108	PAINT	mg / cm ²	SQUARE POOL	EXTERIOR	D	WALL	PLASTER	TAN	Negative	0.30
109	PAINT	mg / cm ²	SMALL POOL	EXTERIOR		FLOOR	PLASTER	WHITE	Negative	0.30
110	PAINT	mg / cm ²	SMALL POOL	EXTERIOR		FLOOR	PLASTER	WHITE	Negative	0.20
111	PAINT	mg / cm ²	SMALL POOL	EXTERIOR		FLOOR	PLASTER	WHITE	Negative	0.30
112	PAINT	mg / cm ²	SMALL POOL	EXTERIOR	D	BENCH	WOOD	BLUE	Negative	0.00
113	PAINT	mg / cm ²	SMALL POOL	EXTERIOR	D	BENCH	WOOD	BLUE	Negative	0.00